

# Messersi TCHR812DMTPP



## GENERAL FEATURES

- Tracked undercarriage with hydrostatic transmission and oscillating rollers in the center of the track for overcoming obstacles.
- The layout of the rubber track provides a wide area and a low ground pressure, high stability and an excellent driving comfort in all conditions of use.
- 18 hp water-cooled Kubota Diesel engine with electric start.
- Pilot assisted travelling control by two levers with automatic return to "neutral" in case of emergency stops.
- Hydrostatic transmission with two piston pumps with variable displacement and two orbital motors. Steering by the rotation of the tracks. Double speed.
- The selfloading shovel of 65 lit. of capacity (option) allows an optimal loading of the body.
- Available with dumping skip with 180° swiveling discharge.
- Hydraulic power take off (P.T.O.) double-effect with max delivery 28 l/min and pressure at 155 bar (optional).
- Standard bonnet and operator platform.

## TECHNICAL DATA

	MTP	CA	BT	AVP
- Operational weight (without operator) kg	750	540	670	770
- Load capacity: - heaped (SAE Standard) m <sup>3</sup>	0,41	0,30	0,45	0,28
- flat: sand m <sup>3</sup>	0,36	0,21	0,36	0,24
- liquid m <sup>3</sup>	0,10	0,21	0,25	0,20
- Max payload kg	1200			

## TECHNICAL DATA

- Diesel Engine		Kubota D722
- Displacement	cm <sup>2</sup>	719
- Cylindres	n°	3
- Max. power at maximum speed	kW/Hp	13.2 / 18
- Maximum engine rotation	rpm	3600
- Max. torque at 2600 rpm	daNm	4.9
- Cooling	type	water
- Battery		12V - 55 Ah
- Piston pumps with variable displacement for the transmission		2 x 30 lt / min at 220 bar
- Gear pump for the services		1 x 21 lt / min at 160 bar
- Track width	mm	180
- Separate tracks steering system		
- Track tensioning	type	spring + screw
- Specific ground pressure:		
- empty / loaded	kg/cm <sup>2</sup>	0.18 / 0.48
- Max speed	km/h	3.5 / 8
- Max gradient capacity fully load	%	62
- Fuel tank capacity	lt	9.7
- Hydraulic oil tank capacity	lt	25.4

## OVERALL DIMENSIONS

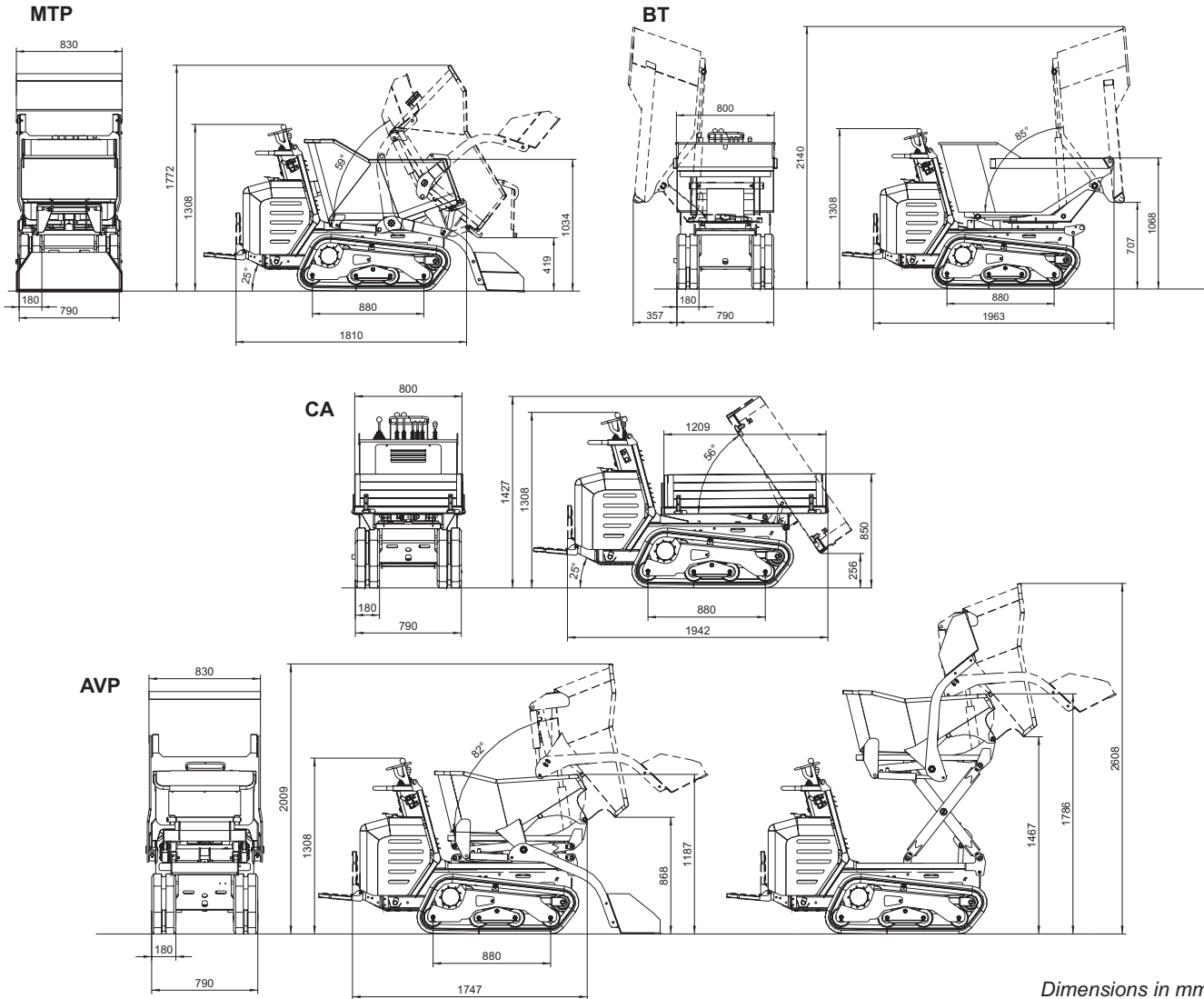

Data, features and pictures are not binding and may be altered without any prior notice.



**MESSERSI' S.p.A.**

Eastern Farm Machinery Ltd. □  
 10 Nicholas Beaver Rd. □  
 Puslinch, On. Canada, N0B 2J0 □  
 T. 5197632400, F 5197633930 □  
 sales@easternfarmmachinery.com



90060-EN